

INFCITY Singapore  
**GOLD CITY**  
 PREMIUM RESIDENTIAL PROJECT  
 Bypass Road, Indore

**Location Plan**

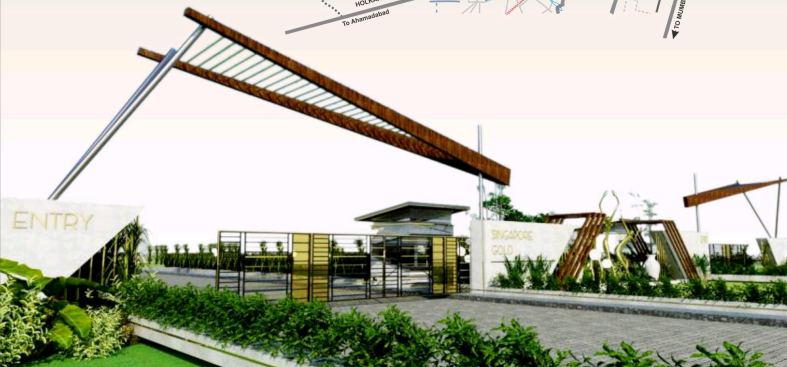

*It is just not a plot,  
 It is a symbol of  
 Grandeur Modern Life Style...*



Land Owner :

**Sunderdeep Constructions  
 Pvt. Ltd.**  
 IDA Sch. No. 114-I, Indore

Brought By :

**SARTHAK  
 VINAYAK  
 Real Built**

12/1, New Palasia, Opp. Bakhatgarh Tower,  
 Cure Well Hospital Road, Indore (M.P)  
 Email : sarthaksingapore@gmail.com  
 Marketing Office :  
 307, The Mark, Saket Square, Indore (M.P)

Site Address :

MR 11, Bypass Road, Arandiya,  
 Near Sheraton Grand Palace,  
 Indore

For details please contact :

96443 24000, 96443 29000

IT&C - INDLP-5415/19/संज्ञा/2019, Date - 26/07/19 | Diversion - 29/अ-2/2078, Date - 13/11/2007  
 Development Permission : 38/2007, Date - 15/11/2007 | Colonizer License : 883/अ.सं./2016/Indore, Date : 23/02/2016

KEP/SP/CP/PH/CS/BS/000/10077

INFCITY Singapore  
**GOLD CITY**  
 PREMIUM RESIDENTIAL PROJECT  
 Bypass Road, Indore

This is only a conceptual presentation of proposed Project & not a legal document. Locations, plans, specifications and estimates shown in this brochure are imaginary & may differ from the original. Further the company reserve all rights regarding this project. Any obligations occur will be settled in India jurisdiction only.



INFOCITY Singapore  
**GOLD CITY**  
 PREMIUM RESIDENTIAL PROJECT  
 Bypass Road, Indore



Available plot Size 1000 sq.ft. (20'x50')      Approved from all concerned departments.      Easy finance available from all leading banks.

**Golden Highlights :**

- ◆ Well connected CC Road network having width range from 30 Ft to 100 Ft.
- ◆ Gated secured community with four side boundary wall, CCTV cameras & 24x7 security by petrolling Guards.
- ◆ Integrated Landscaping including water bodies on theme based garden.
- ◆ Environmental friendly waste disposal & water conservation techniques.
- ◆ Located at most happening area of the bypass.
- ◆ Situated in the proximity of around 2000 habited families.
- ◆ Fully approved township.

**Premium Destination**

- ◆ Singapore Gold City to GEMS School - 1 Kms.
- ◆ Singapore Gold City to The Grand Bhagwati Palace - 1.5 Kms.
- ◆ Singapore Gold City to MR-12 junction - 1.5 Kms.
- ◆ Singapore Gold City to MR-11 junction - 2 Kms.
- ◆ Singapore Gold City to DPS School - 3 Kms.
- ◆ Singapore Gold City to Bombay Hospital - 8 Kms.



INFOCITY Singapore  
**GOLD CITY**  
 PREMIUM RESIDENTIAL PROJECT  
 Bypass Road, Indore

**Location Plan**

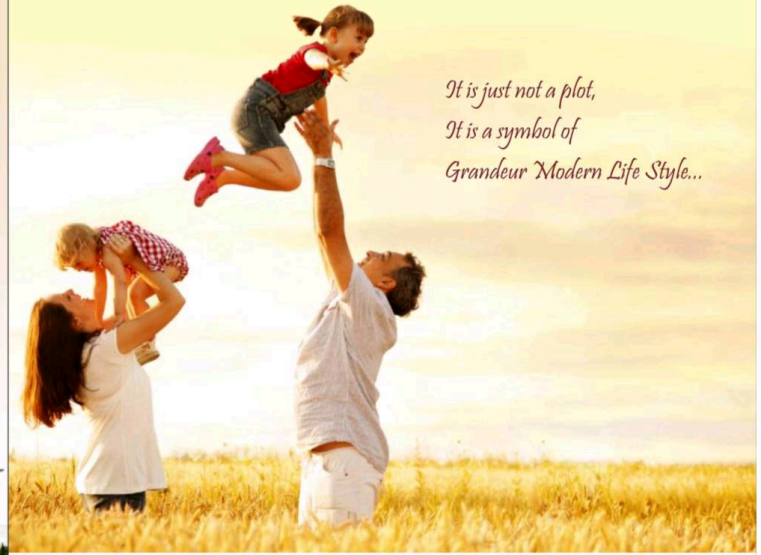

*It is just not a plot,  
 It is a symbol of  
 Grandeur Modern Life Style...*

Land Owner:  
**Sunderdeep Constructions Pvt. Ltd.**  
 IDA Sch. No. 114-4, Indore

Brought By:  
**SARTHAK VINAYAK Real Built**  
 12/1, New Palasia, Opp. Bakhatgarh Tower,  
 Cure Well Hospital Road, Indore (M.P.)  
 Email: sarthaksingapore@gmail.com  
 Marketing Office:  
 307, The Mark, Saket Square, Indore (M.P.)

Site Address:  
 MR 11, Bypass Road, Arandiya,  
 Near Sheraton Grand Palace,  
 Indore

For details please contact:  
**96443 24000, 96443 29000**

IT&C - INDLP-5415/19/ 2019, Date - 26/07/19 | Diversion - 29/\*-2 / 2078, Date - 13 / 11 / 2007  
 Development Permission : 38/2007, Date - 15/11/2007 | Colonizer License : 883/\*R./2016/Indore, Date : 23/02/2016

INDP/2016/IND/14/8000/2017

INFOCITY Singapore  
**GOLD CITY**  
 PREMIUM RESIDENTIAL PROJECT  
 Bypass Road, Indore



INFOCITY Singapore  
**GOLD CITY**  
 PREMIUM RESIDENTIAL PROJECT  
 Bypass Road, Indore



Available plot Size 1000 sq.ft. (20'x50')  
 Approved from all concerned departments.  
 Easy finance available from all leading banks.

**Golden Highlights :**

- Well connected CC Road network having width range from 30 Ft to 100 Ft.
- Gated secured community with four side boundary wall, CCTV cameras & 24x7 security by petrolling Guards.
- Integrated Landscaping including water bodies on theme based garden.
- Environmental friendly waste disposal & water conservation techniques.
- Located at most happening area of the bypass.
- Situated in the proximity of around 2000 habited families.
- Fully approved township.

**Premium Destination**

- Singapore Gold City to GEMS School - 1 Kms.
- Singapore Gold City to The Grand Bhagwati Palace - 1.5 Kms.
- Singapore Gold City to MR-12 junction - 1.5 Kms.
- Singapore Gold City to MR-11 junction - 2 Kms.
- Singapore Gold City to DPS School - 3 Kms.
- Singapore Gold City to Bombay Hospital - 8 Kms.

